

TYPICAL RAIL ELEMENT

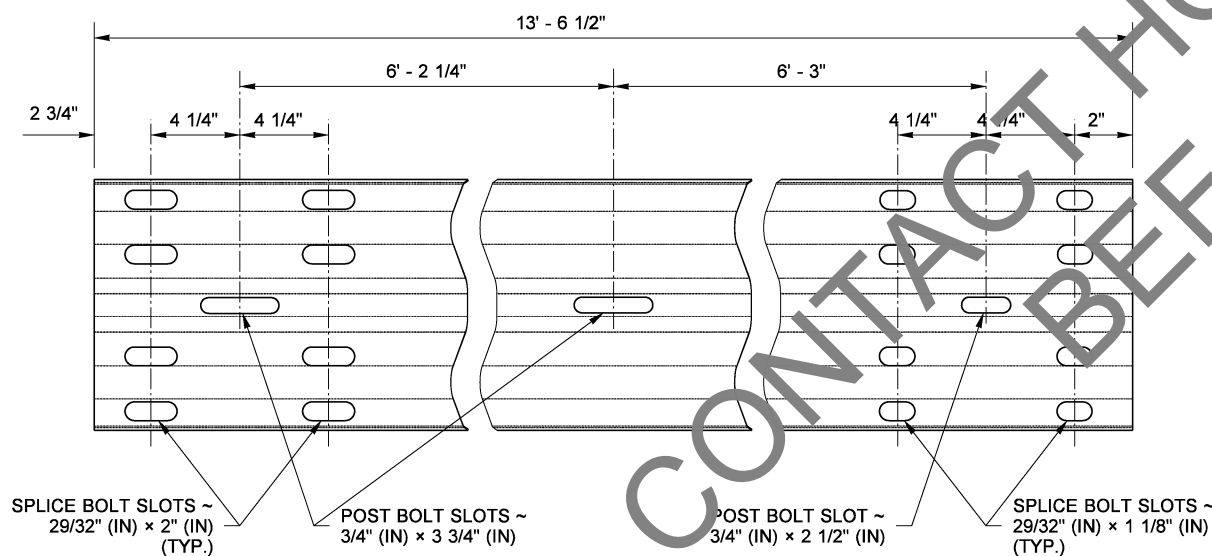

EXPANSION SECTION

NOTES

1. Timber blocks shall be toe-nailed to the post with a 16d galvanized nail to prevent block rotation.
2. For post and block details, see Standard Plan C-1b.
3. When "Beam Guardrail Type - Ft. Long Post" is specified in the Contract, the post length shall be stamped with numbers, 1 1/2" (in) min. high and 3/4" (in) wide at the location where the letter "H" is shown in the ASSEMBLY DETAIL. For wood post applications, the letter shall be stamped to a minimum depth of 1/4" (in). For steel post applications, the letter shall be legible after the post is galvanized. After post installation it shall be the Contractor's responsibility to ensure the stamped numbers remain visible.
4. Existing posts shall not be raised. Replace posts as necessary to achieve required guardrail height.
5. Holes shall be located on approaching traffic side of web.

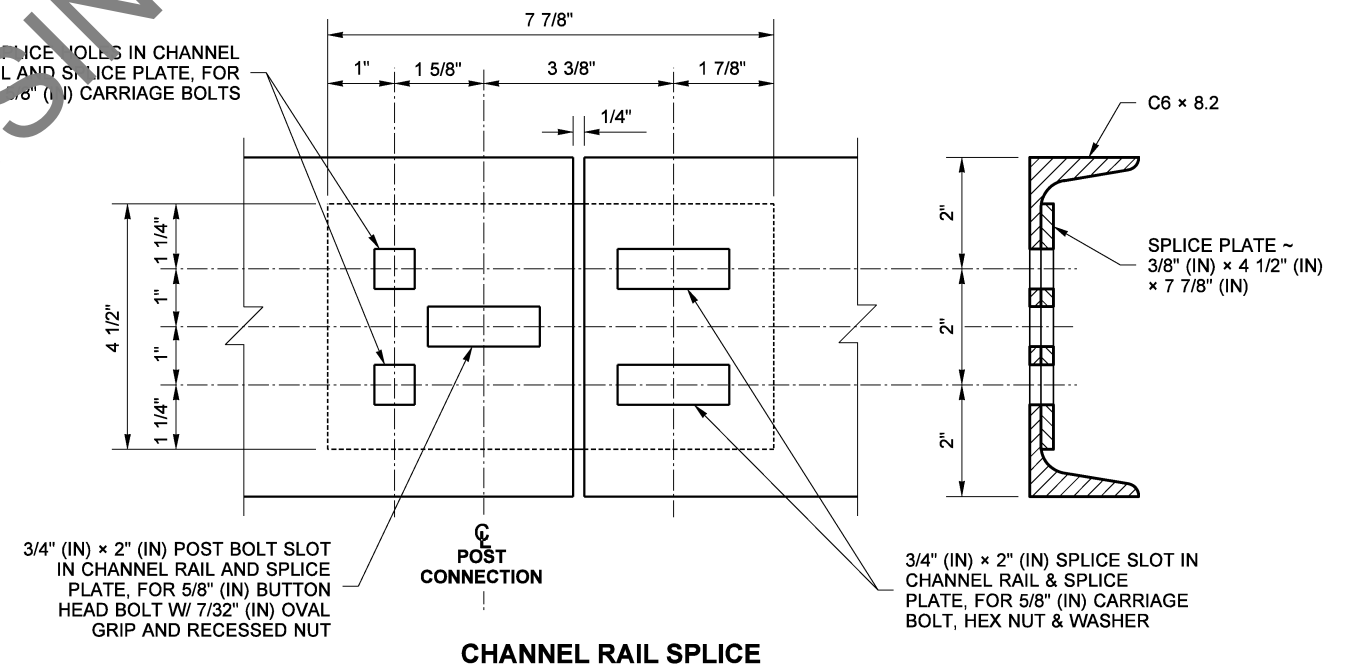

FILE NAME		S:\Design R P & S4-Standards\2-Plan Sheet Library\01-Master PSL(TB) Traffic Barrier(TB-C) conversions 2022\TB-108(c20.11) e.dgn		FED.AID PROJ.NO.		Washington State Department of Transportation		BEAM GUARDRAIL TYPE 1 COMPONENTS		PLAN REF NO TB-108	
TIME	9:21:00 AM	REGION NO.	10	STATE	WASH	DATE		DATE		SHEET 1 OF 1 SHEETS	
DATE	10/18/2022	JOB NUMBER	CONTRACT NO.		LOCATION NO.		P.E. STAMP BOX		P.E. STAMP BOX		
PLOTTED BY	liddelf	REVISION		DATE		BY					
DESIGNED BY											
ENTERED BY											
CHECKED BY											
PROJ. ENGR.											
REGIONAL ADM.											